

JNCI



JNCI-30
JNCI-30/50 Cap

- Cream container with simple rounded shape.
- Capacity: 30ml.
- Airtightness preserved by induction wads.
- Versatile decoration possibility.
- Looks and feel much bigger than the capacity.

JNCI-30 Specification

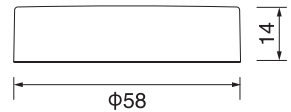
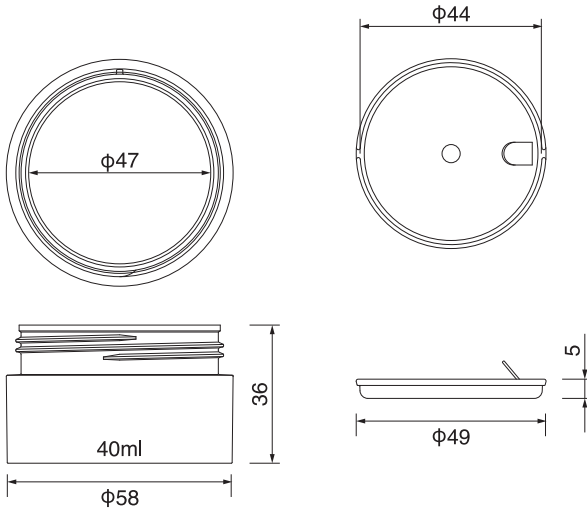

JNCI-30/50 Cap

Material / PP
Molding / I
Weight / 8.3g



JNCI-30

Material / PP
Molding / I
Weight / 15.2g

JNCI-30/50 Lid

Material / LLDPE
Molding / I
Weight / 2.2g

JNCI-30/50 Bottom Cover

Material / PP
Molding / I
Weight / 4.5g

JNCI



JNCI-50
JNCI-30/50 Cap

- Cream container with simple rounded shape.
- Capacity: 50ml.
- Airtightness preserved by induction wads.
- Versatile decoration possibility.
- Looks and feel much bigger than the capacity.

JNCI-50 Specification

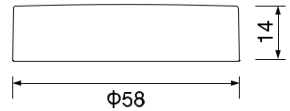
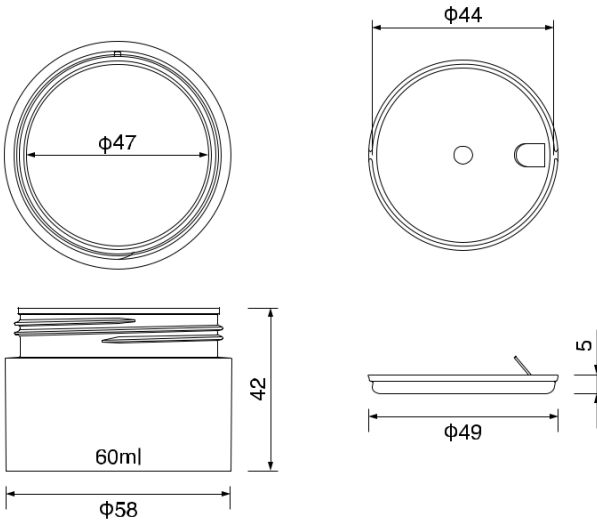

JNCI-30/50 Cap

Material / PP
Molding / I
Weight / 8.3g



JNCI-50

Material / PP
Molding / I
Weight / 18.6g

JNCI-30/50 Lid

Material / LLDPE
Molding / I
Weight / 2.2g

JNCI-30/50 Bottom Cover

Material / PP
Molding / I
Weight / 4.5g

JNCi



JNCi-100
CPTI-64φ Cap

- 100ml cream container with simple round shape.
- Airtightness can be preserved with the inner lid.
- Appears larger than the actual capacity.
- Variety of decoration possibilities for jar and cap.

JNCi-100 Specification

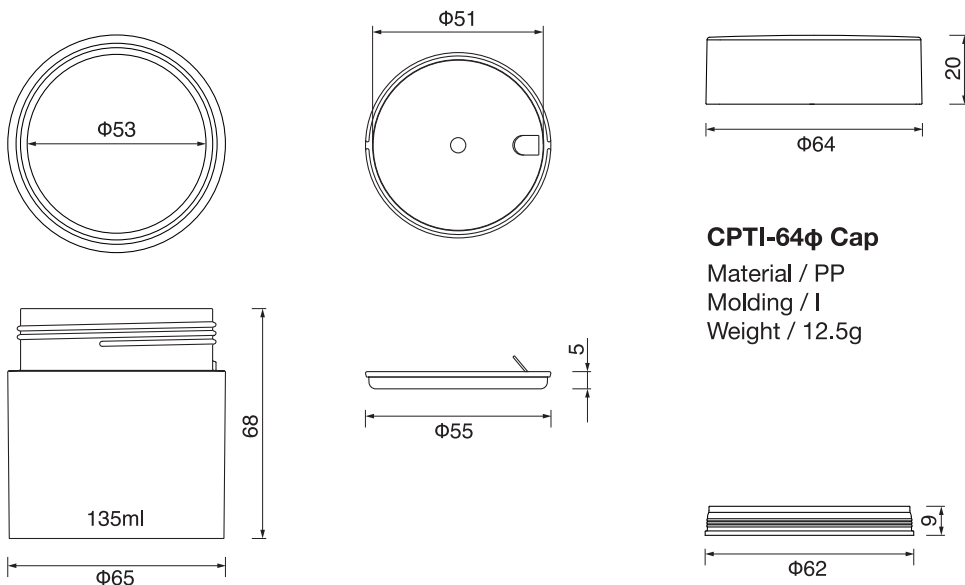

CPTI-64φ Cap

Material / PP
Molding / I
Weight / 12.5g

JNCi-100

Material / PP
Molding / I
Weight / 34.0g

JNCi-100 Inner Lid

Material / LLDPE
Molding / I
Weight / 3.4g

JNCi-100 Bottom Lid

Material / PP
Molding / I
Weight / 5.4g